

## Erste mToken

Access mBanking and NetBanking  
in a more secure and simple way



Download the free apps from:



or



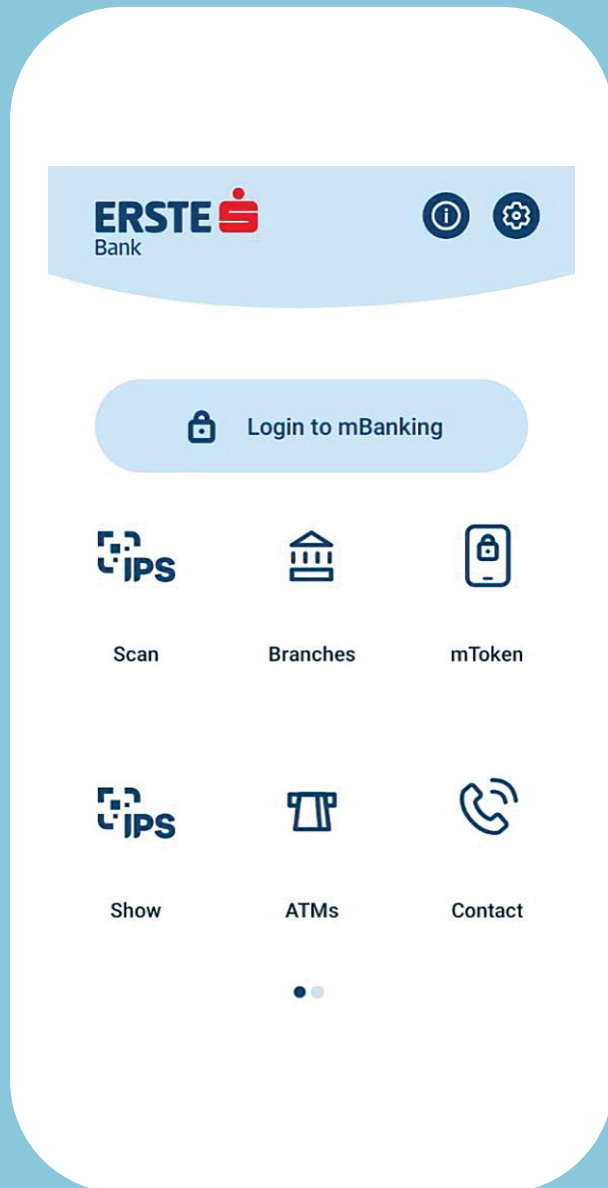

## What is Erste mToken?

Erste **mToken** is a means for login to e-banking and mobile banking services, and it is an integral part of the Erste mBanking application.

This means you can log in to NetBanking and mBanking not only via the **TAN card**, but using mToken, as well. This ensures a simpler, safer and contemporary access to e-business.

mToken can be activated on maximum 3 devices. The new mToken can be activated on the same device once the existing mToken is blocked.

## “mToken”

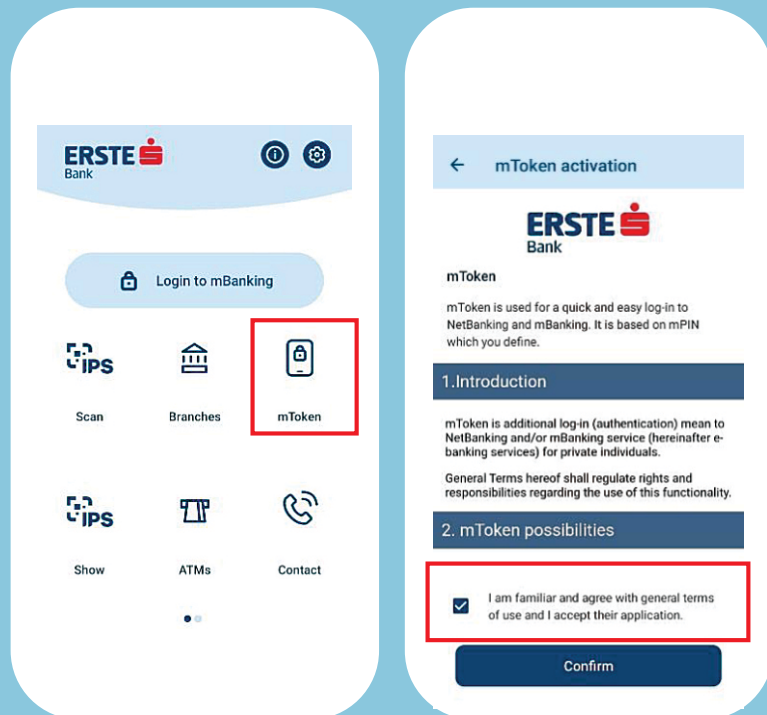

## “Login to mBanking”



mToken can be activated only via the TAN card by clicking on the “mToken” icon or “Login to mBanking” icon on the home screen in the mBanking application. The first step is to accept the General Terms and Conditions for activating mToken.

# mToken Activation

After accepting the General Terms and Conditions, please enter your username (**in capital letters**) and password.

1

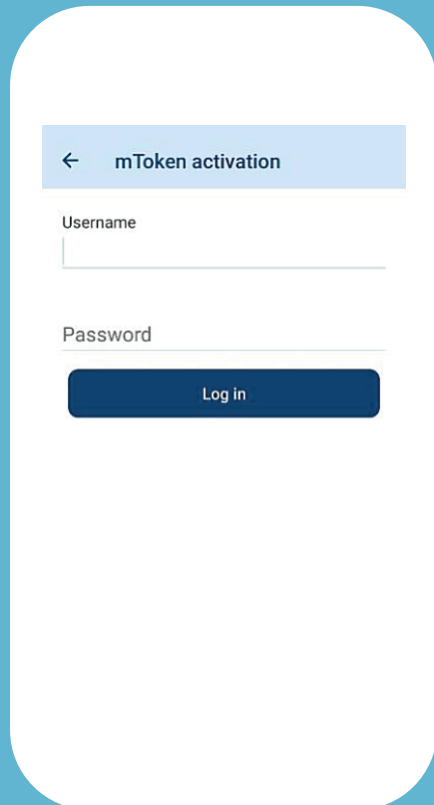

← mToken activation

Username

Password

Log In

The next step is to enter the appropriate field from the TAN card (**row and column**).

2

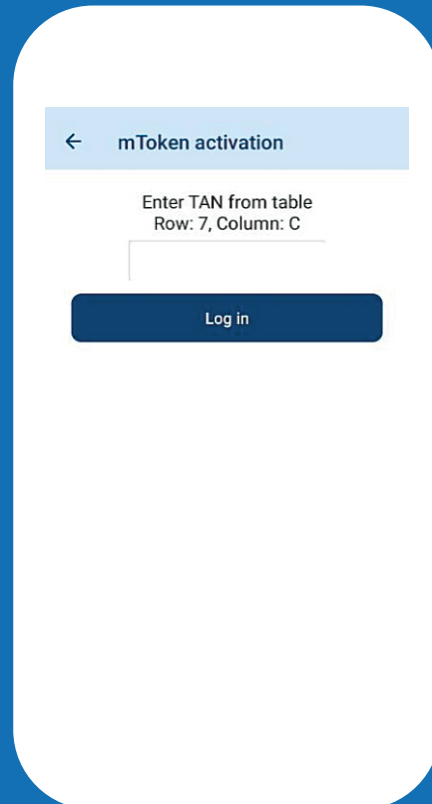

← mToken activation

Enter TAN from table  
Row: 7, Column: C

Log in

Before activating mToken, please select mPIN (**4-digit number** related to mToken) which is intended for login to mBanking and NetBanking.

3

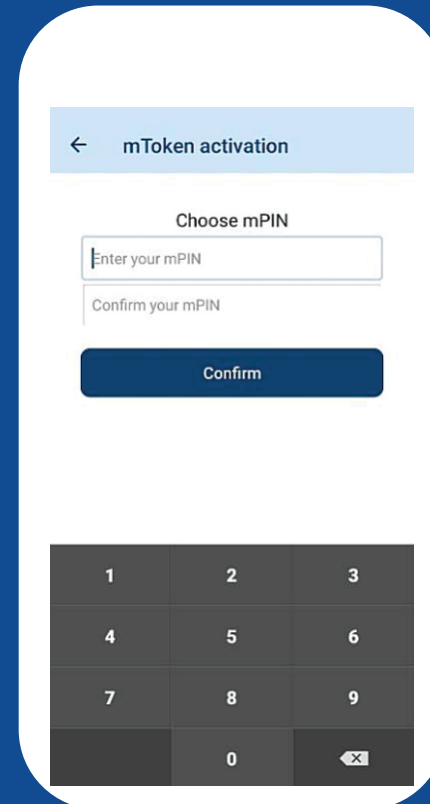

← mToken activation

Choose mPIN

Enter your mPIN

Confirm your mPIN

Confirm

1	2	3
4	5	6
7	8	9
	0	✕

In the final step of the activation, the application offers the option to set up mToken as a **predefined login method**.

4

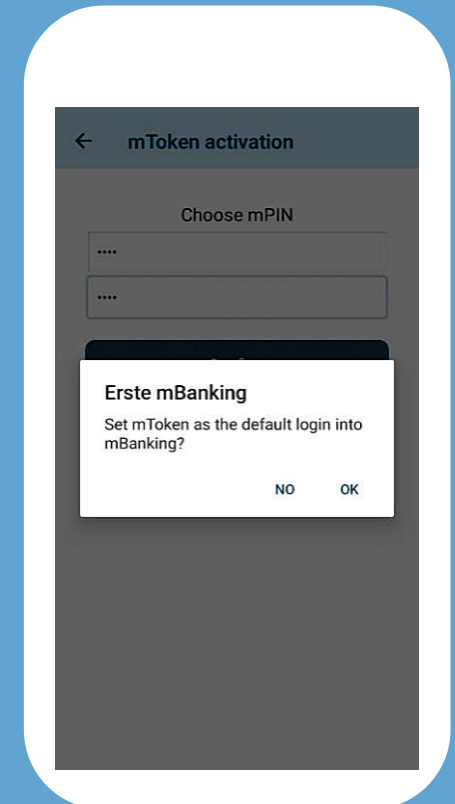

← mToken activation

Choose mPIN

Erste mBanking

Set mToken as the default login into mBanking?

NO OK

# Setting up mToken as a predefined method of login to mBanking

1

## Setup via the "Login to mBanking" icon

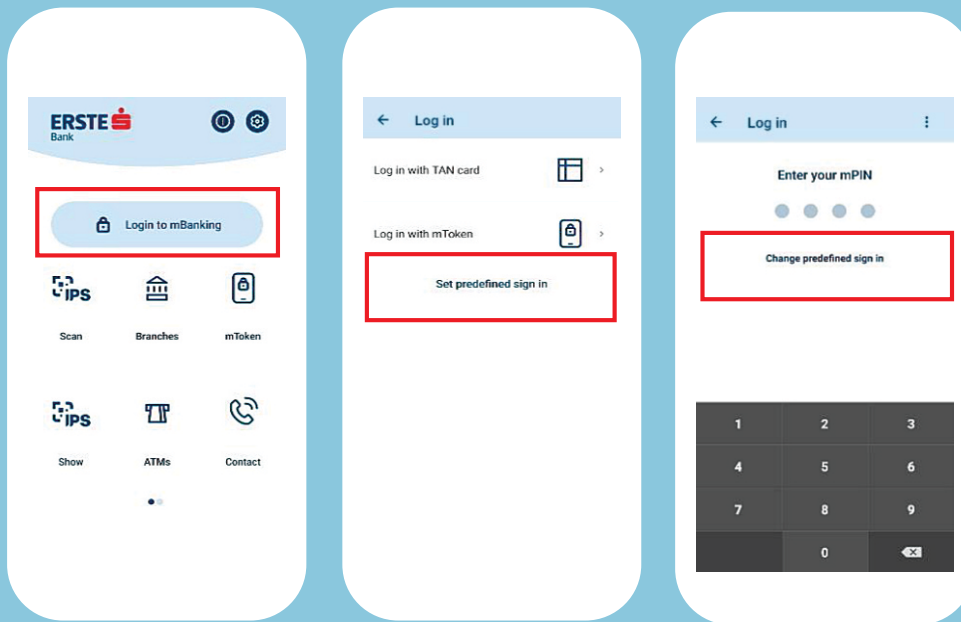

2

## Setup via the "Settings" icon

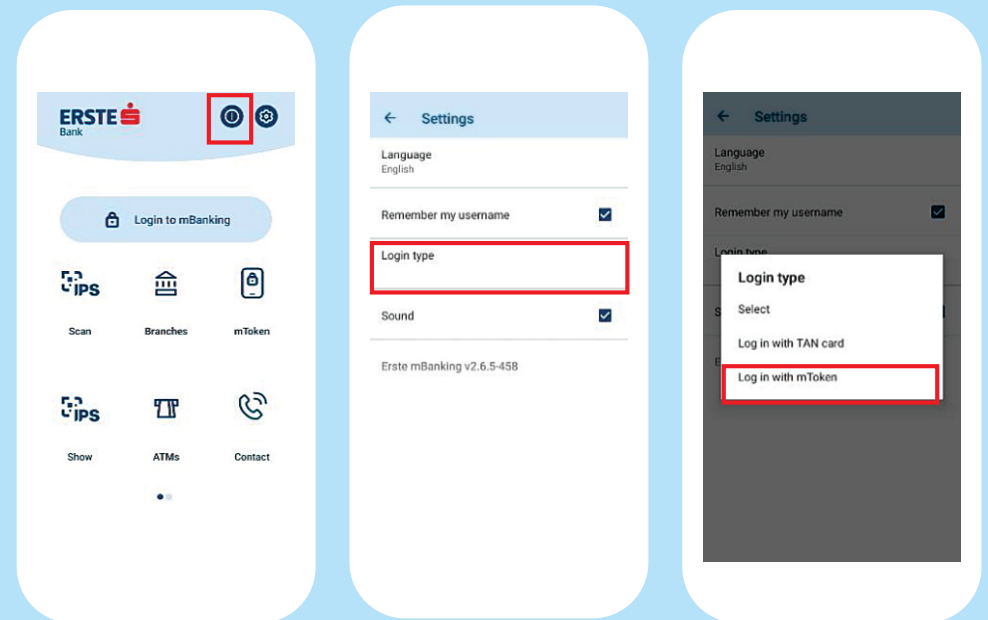

In order to log each time to mBanking by entering your defined 4-digit mPIN, please set mToken as a predefined method of login to mBanking. This can be done:

- via the **"Login to mBanking"** icon on the login method selection screen or the mPIN input screen,
- via the **"Settings"** icon,
- on the screen that is displayed last **during mToken activation** (shown on page 4).

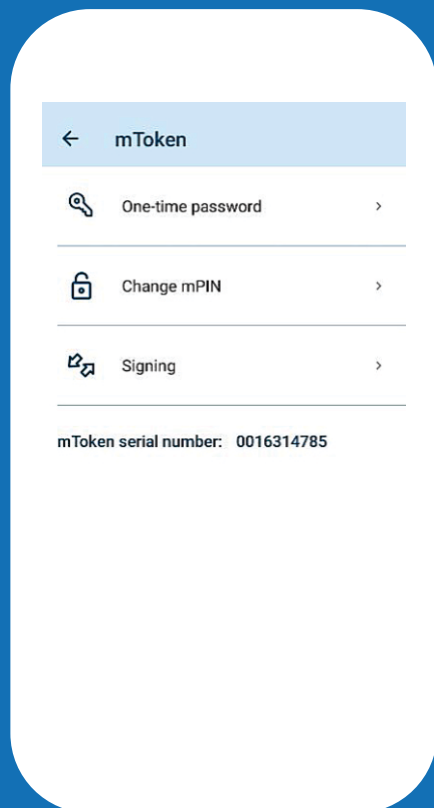

## One-time password

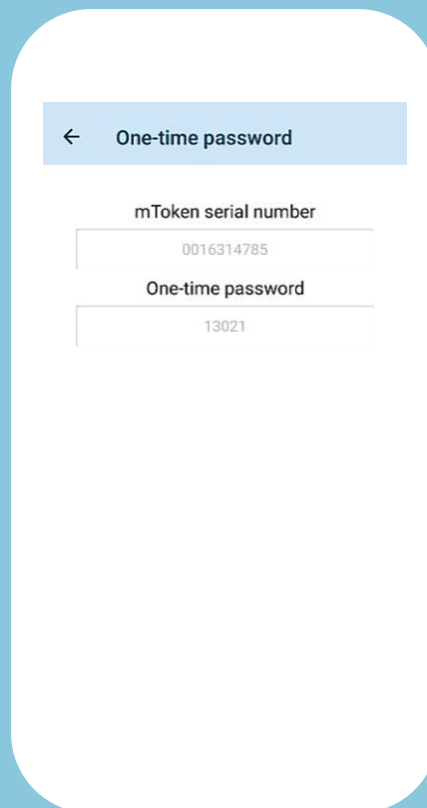

## Change mPIN

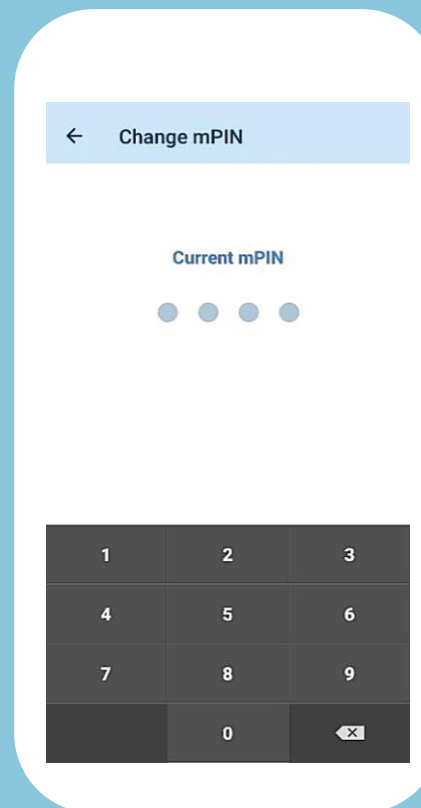

## Signing

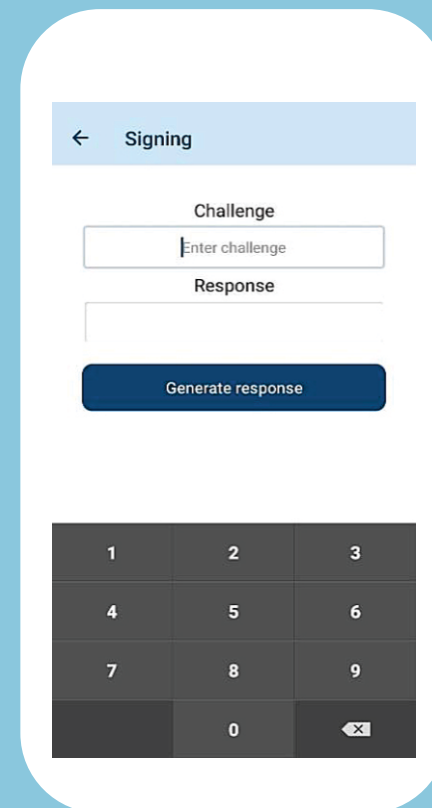

## The options offered by mToken

Once Erste mToken is activated, you can use the "mToken" icon to:

- Create a one-time password for logging to NetBanking
- Change mPIN
- Sign a payment order on NetBanking

# Login to NetBanking via mToken

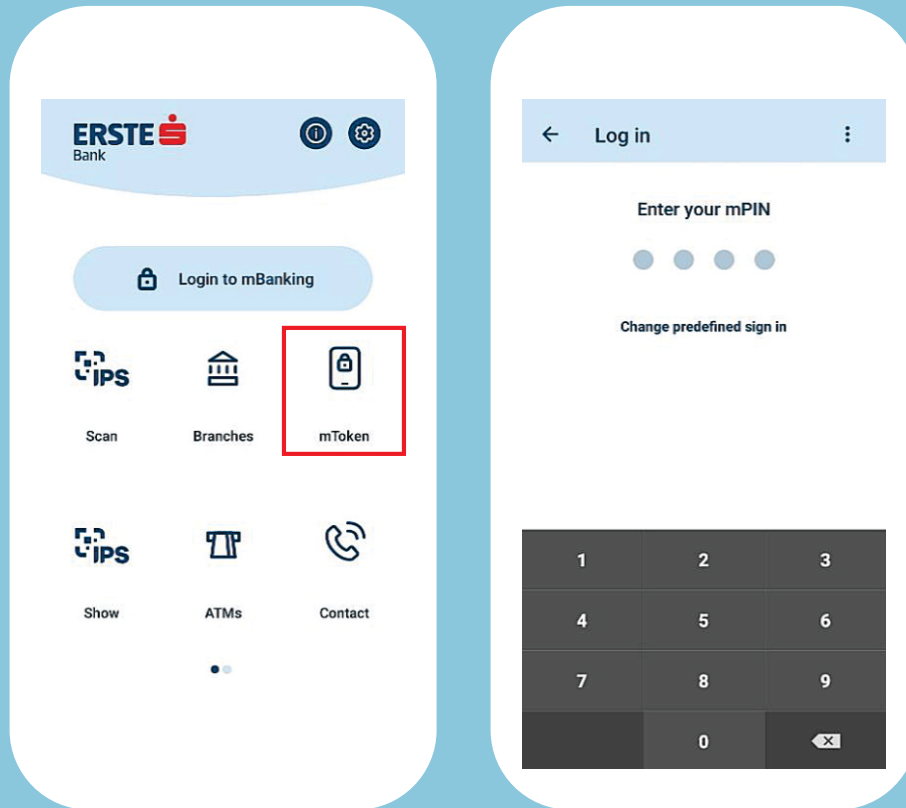

1

To log in to NetBanking, you should first enter the mPIN you defined when mToken was activated.

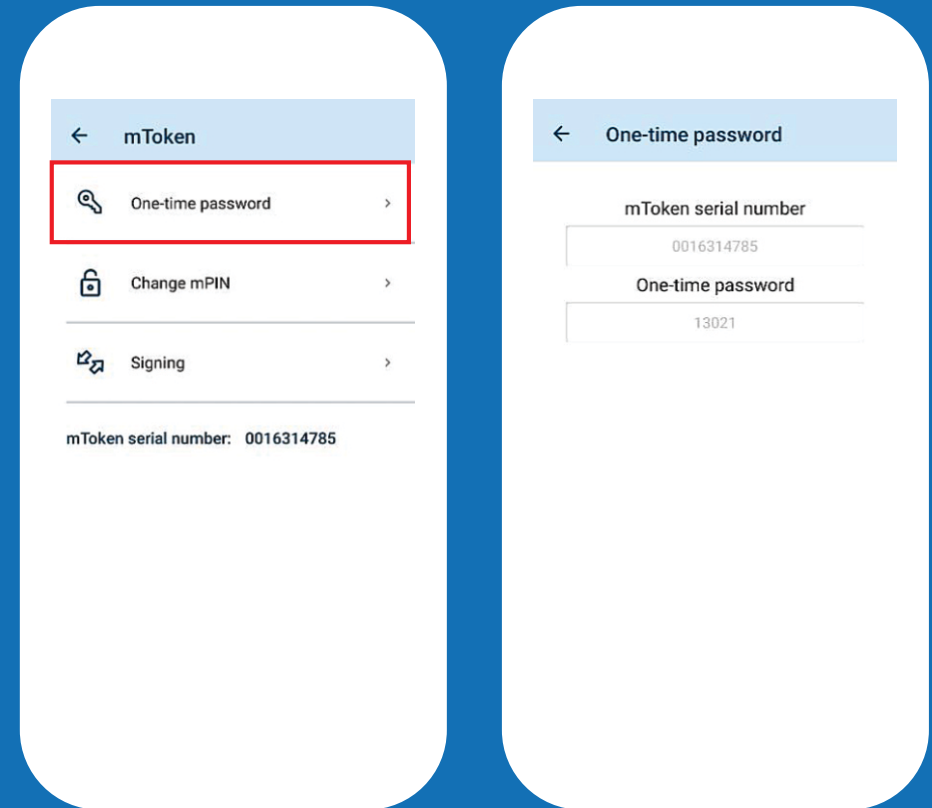

2

When you click on a “One-time password” icon, the information required to log in to NetBanking will be displayed:

- mToken serial number
- One-time password

# Signing a payment order on NetBanking with mToken

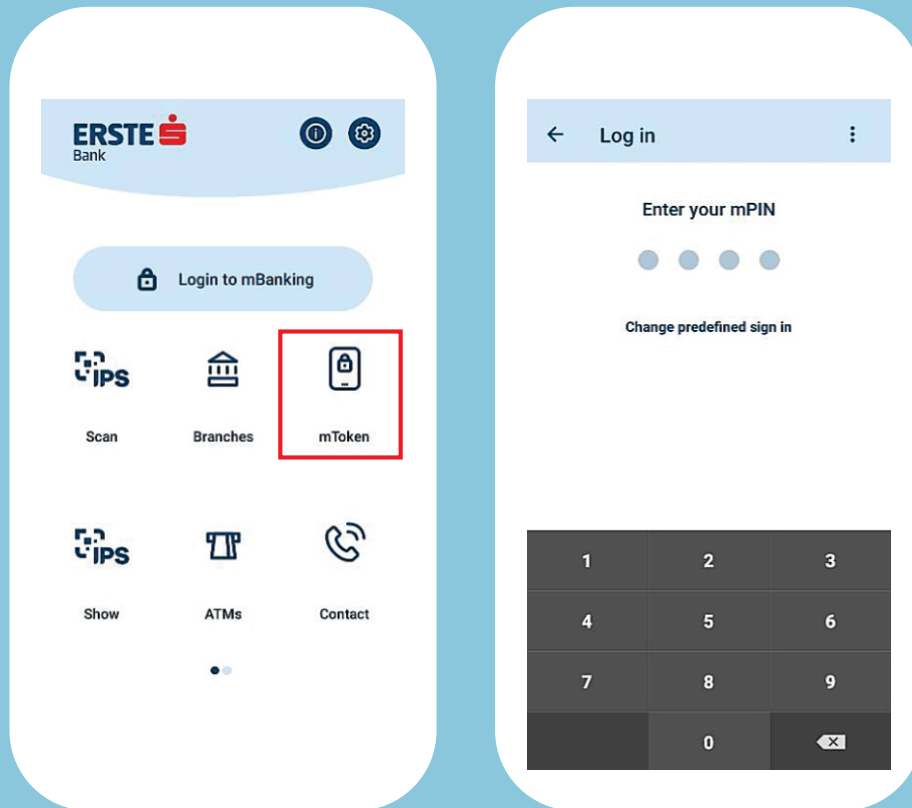

1

To sign a payment order on NetBanking, you should first enter the mPIN you defined when the mToken was activated.

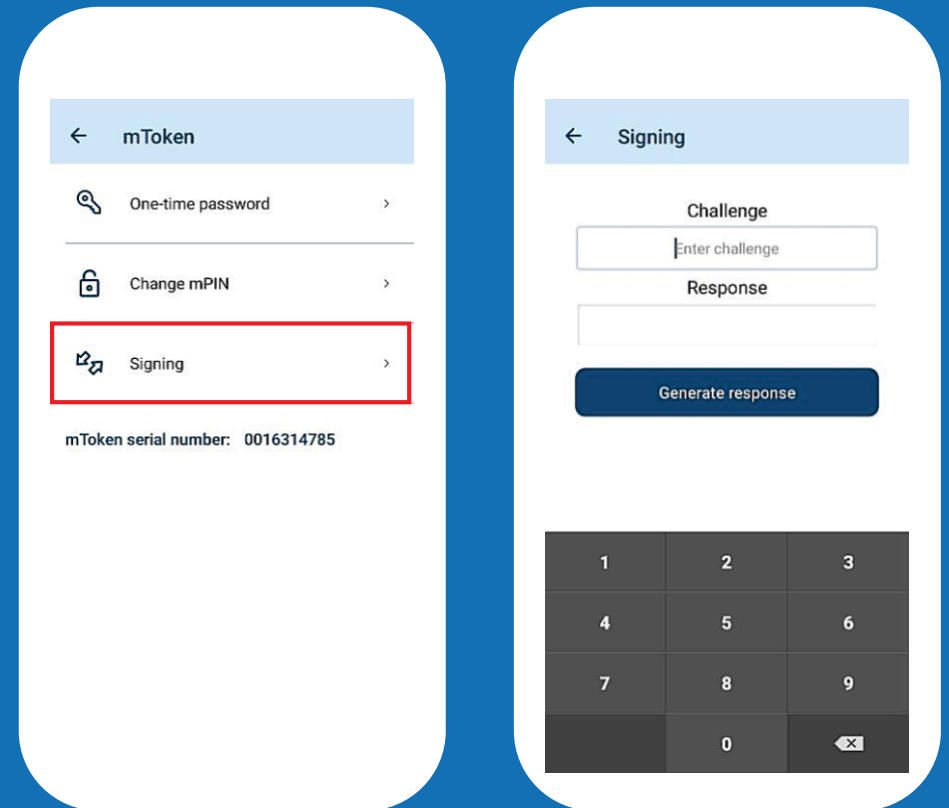

2

When you click on "Signing", the screen displaying the information to be signed will be opened. Please enter the number from NetBanking enquiry in the "Challenge" field. When you click on "Generate response", the number which should be entered in NetBanking to sign the payment order will appear in "Response" field.



# Change mPIN

1

To change the mPIN, you should first enter the mPIN you defined when mToken was first activated.

2

Select the "Change mPIN" option.

3

Enter the current mPIN you want to change.

4

Enter the new mPIN you want to use in the future.

5

Confirm the new mPIN you want to use in the future.

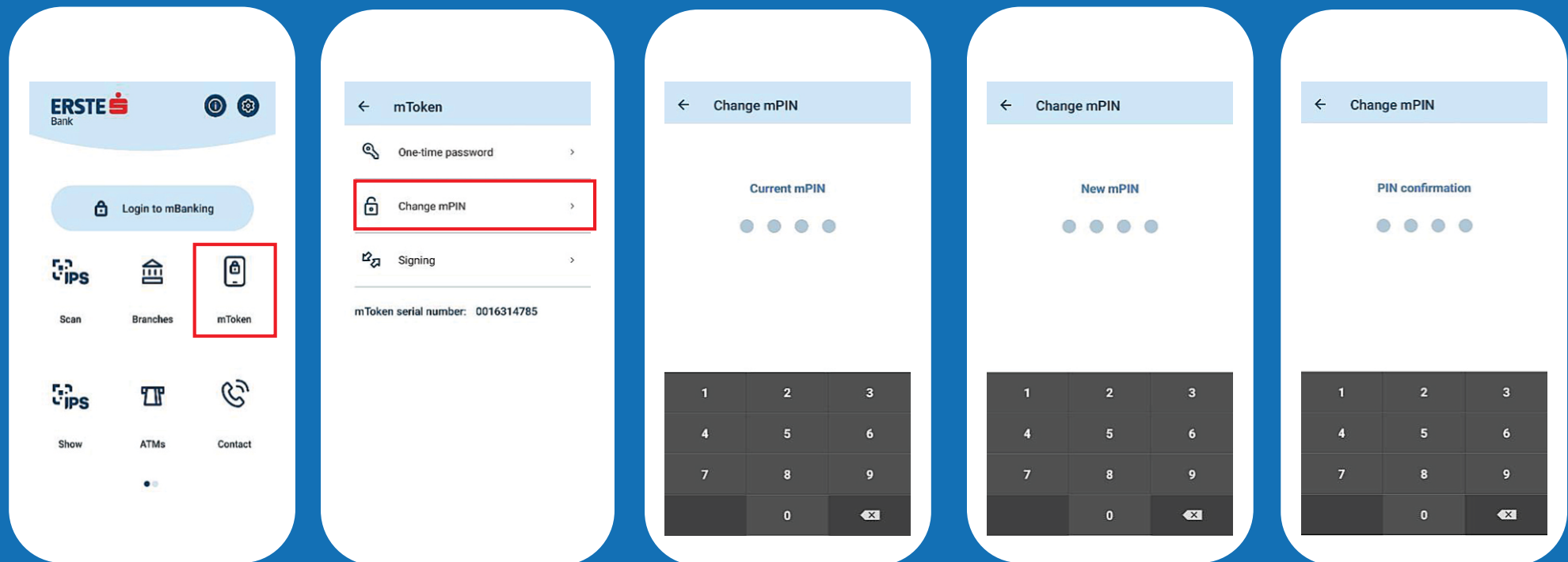

# Blocking mToken

1

You can block mToken by clicking the icons:

- Login to mBanking
- mToken

2

The mPIN input window will open. Please click on the three dots in the upper right corner of the screen.

3

Once a new window is opened, select "Block mToken".

4

Confirm by clicking the „Yes“ option.

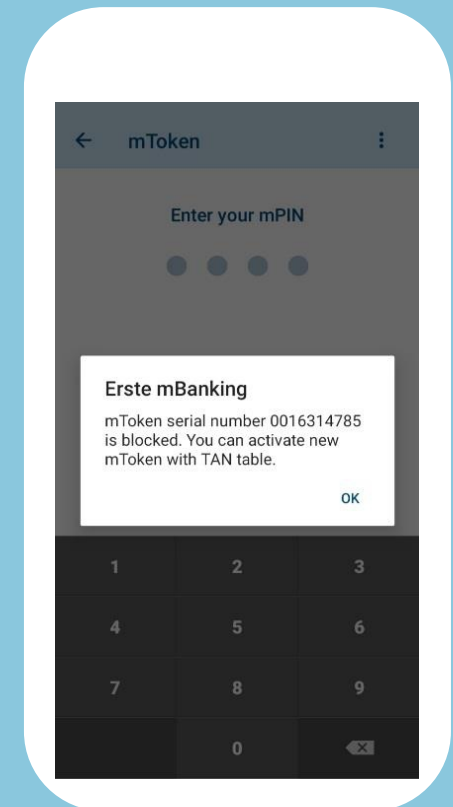
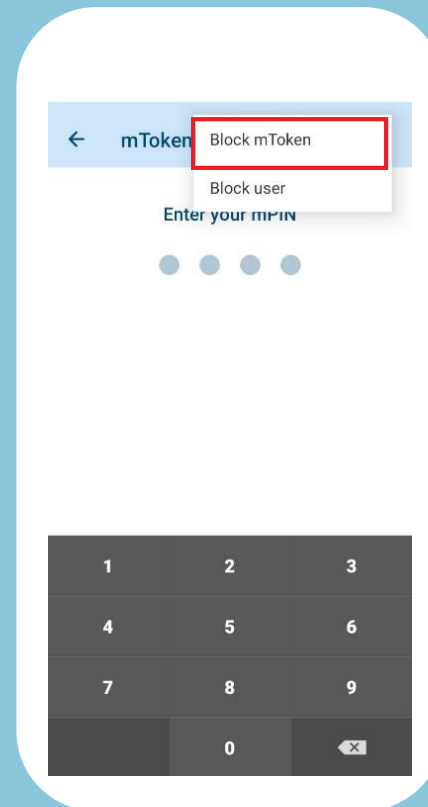
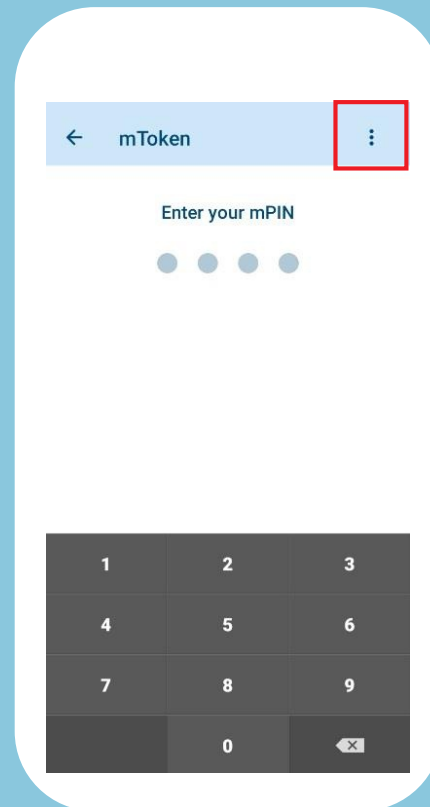
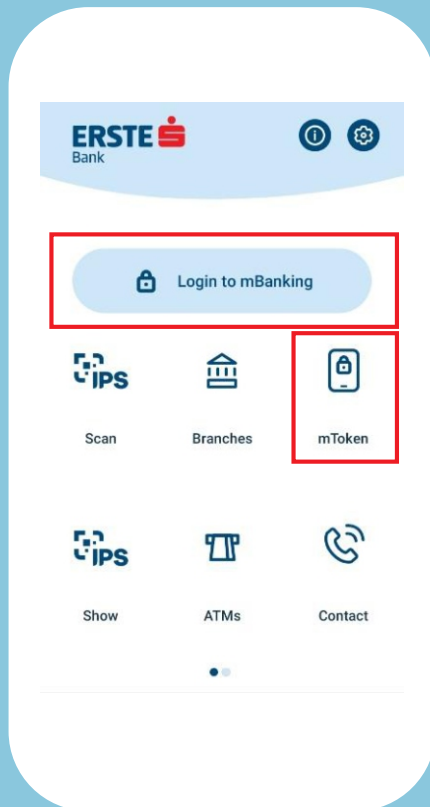



Erste Banka Srbija



Erste Bank Serbia

Erste phone: 0800 201 201, 060 48 48 000

[www.erstebank.rs](http://www.erstebank.rs)

**ERSTE**   
Bank